

Rue Michel Lentz

LOT N°1B

NIV. REF.: ±0.00

AXE FACADE

TROTTOIR

DEMANDE DE MORCELLEMENT

1901/7051

Commune: ETTTELBRUCK
Section: C d'ETTELBRUCK
Contenance: 05a70ca
Lieu-dit: Rue Michel Lentz

ALIGNEMENT VOISIN

NOUVELLE LIMITE

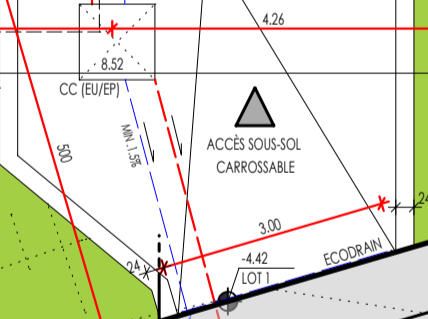
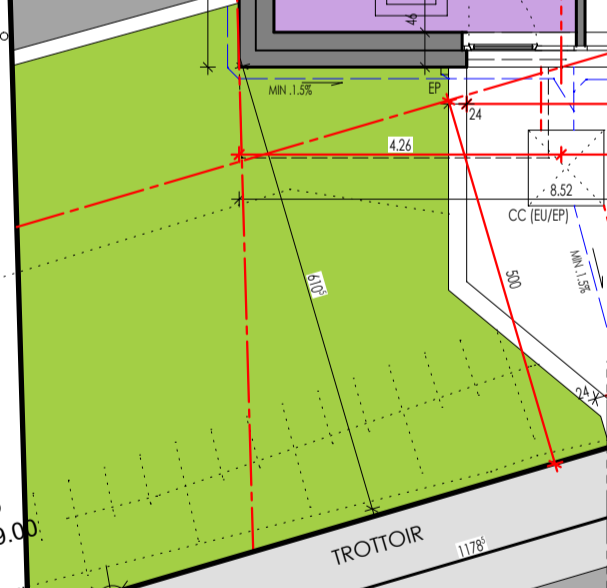
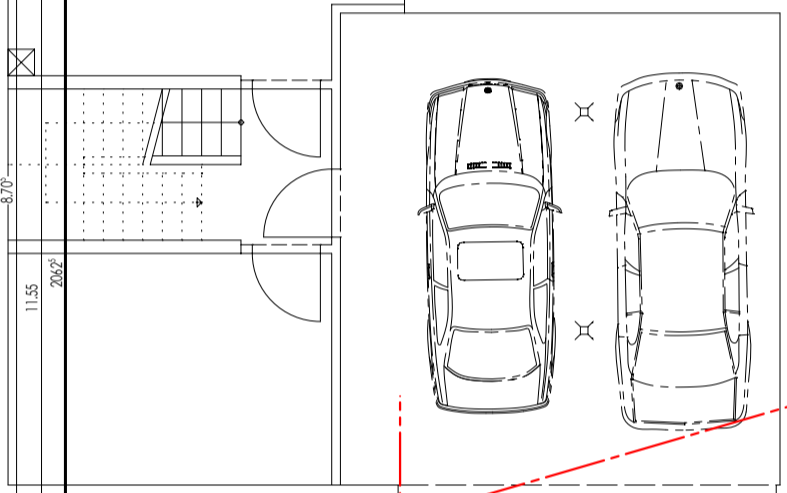
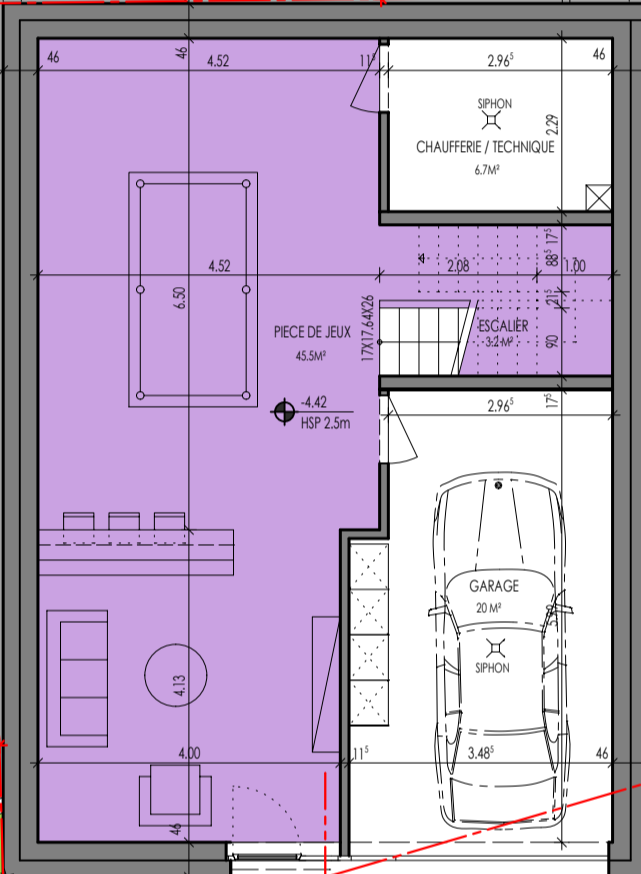

Rue Jean-Antoine Zinnen

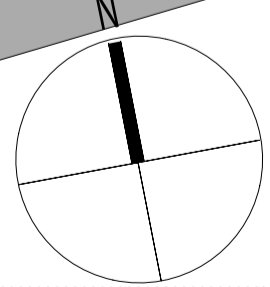

CLIENTS: OKYAY/COLM_3/7/2017

SOUS-SOL
ECH.:1/100

SCHEMA RACCORDEMENT SUR LA CANALISATION PUBLIQUE

